

Bosworth St: Existing STR

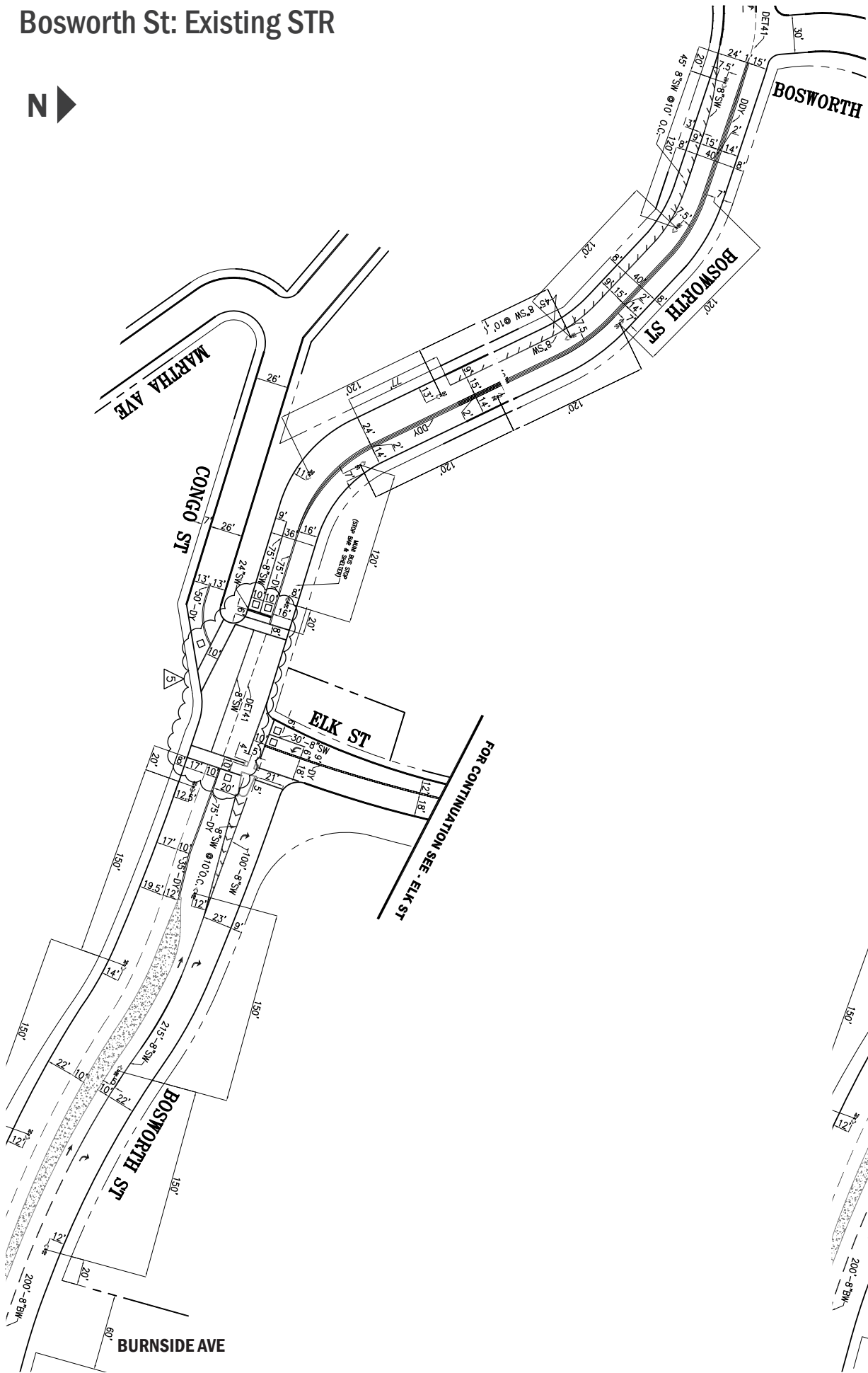

Bosworth St: Proposed STR

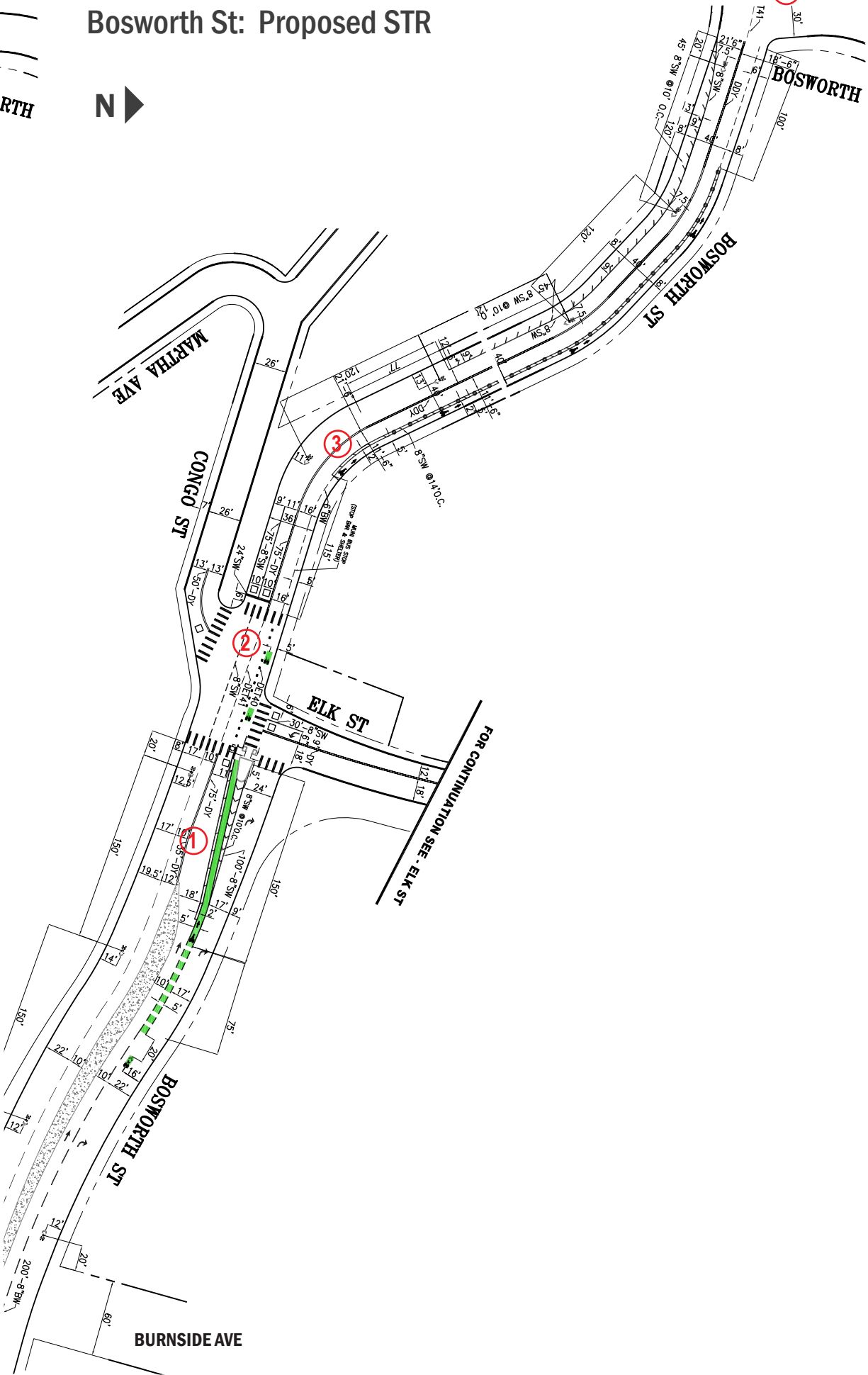

Proposed Changes

- 1. Add bike lane from Bosworth St. and Elk St. to 225' easterly
- 2. Add intersection markings including continental crosswalks and greenback sharrows at Bosworth St. and Elk St.
- 3. Adjust center-line on Bosworth St. from Elk St. to the O'Shaughnessy Path and add 5' curbside bike lane with 2' buffer.
- 4. Add sign at beginning of O'Shaughnessy Path at Bosworth to indicate start of shared bike/pedestrian pathway.